

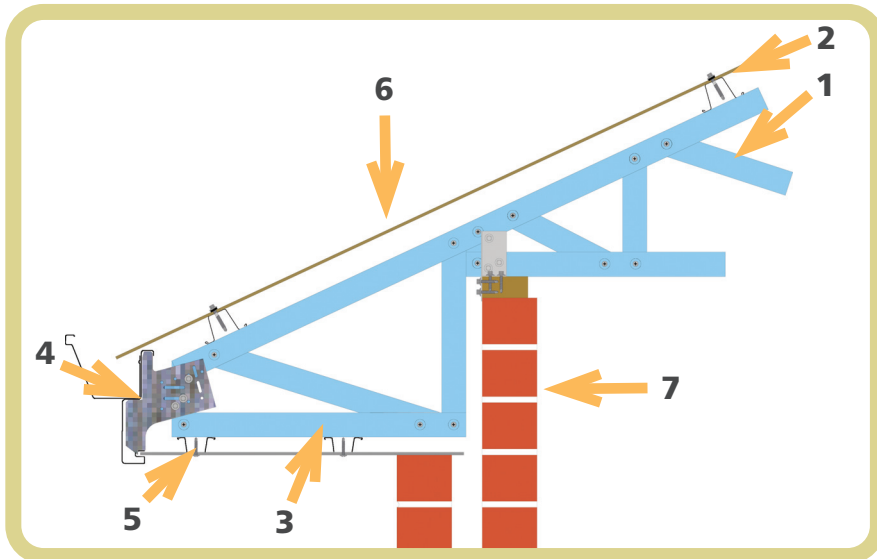

Building in Bushfire prone areas – Technical Information

A **BAL (Bushfire Attack Level)** is a means of measuring a building's potential exposure to ember attack, radiant heat and direct flame contact, in a bushfire event. It is a basis for establishing the requirements for construction to improve protection of building elements from attack by bushfire.

BAL-12.5	Low Risk	Risk of ember attack
BAL-19	Moderate Risk	Risk of ember attack and burning debris ignited by wind borne embers and a likelihood of exposure to radiant heat.
BAL-29	High Risk	Increased risk of ember attack and burning debris ignited by wind borne embers and a likelihood of exposure to radiant heat.
BAL-40	Very High Risk	Much increased risk of ember attack and burning debris ignited by wind borne embers, a likelihood of exposure to a high level of radiant heat and some likelihood of direct exposure to flames from the fire front.



1. CMI steel roof truss
2. CMI steel roof batten
3. CMI steel eaves support frame
4. CMI steel fascia (gutter optional)
5. Eaves lining
6. CMI steel roof sheeting
7. Double brick or CMI steel frame system

Steel Roofing Systems

As steel roofing is non-combustible, when built in accordance with Fig 1.1 above, a steel roof structure fully complies with BAL 12.5-BAL40 requirements. This means that, at lower BAL levels, the protection against bushfire attack afforded by a non-combustible steel roof system is substantially greater than the minimum required, giving reassurance and peace of mind. The CMI Steel Roofing System is a cost effective, structurally engineered roofing system that satisfies up to and including BAL 40 requirements.

So if you are planning to build in a bush fire prone zone the only choice is steel

This document should be read in conjunction with **NASH STANDARD STEEL FRAMED CONSTRUCTION IN BUSHFIRE AREAS 2014**



Perth
17-23 Hoskins Rd, Landsdale
T: (08) 9309 1303
E: sales@cmiwa.com.au

Busselton
22 Cook Street, Busselton
T: (08) 9754 3884
E: busselton@cmiwa.com.au

Geraldton
2a Larkin Street, Wonthella
T: (08) 9921 1399
E: geraldton@cmiwa.com.au



Innovators in steel
www.cmiwa.com.au